

KALDEWEI

Europe's No.1 for baths

MULTIVERSO.

TECHNICAL INFORMATION.



PERFECT PANELLING. OPTIMAL ACCESS TO WHIRL TECHNOLOGY.

MULTIVERSO. THE NEW PANELLING SYSTEM FOR WHIRL BATHS.

The new MULTIVERSO panelling system is perfectly matched to all Kaldewei whirl baths. It is not only ideal for panelling rectangular, hexagonal, octagonal and oval Kaldewei baths, MULTIVERSO is also easily adaptable to a wide variety of installation situations. Whether in a niche, a corner, against a wall or freestanding, MULTIVERSO always fits the task at hand – and can be assembled rapidly. But its most ingenious feature is that MULTIVERSO allows for ventilation of the whirlpool system and affords optimal access to the whirl technology. And its surface can be finished in a choice of materials including tile, marble or wood.

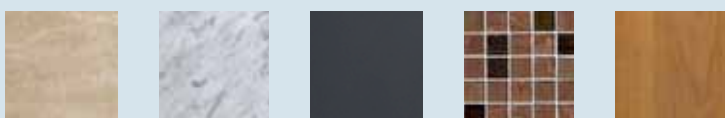

A few examples of possible finishes.



KEY BENEFITS AT A GLANCE.



MULTIVERSO. PERFECTLY MATCHED TO KALDEWEI WHIRL BATHS.

No matter whether the whirl bath is installed on an unfinished or covered floor (e.g. tiles), MULTIVERSO is always mounted on the finished floor. The lack of a base means that the user always has optimal access to the whirl technology. MULTIVERSO can be adjusted using the scale on every support element in a height range of 39 to 61 cm. The panelling has an overlap of 8 cm, which is sufficient for all the design-based overlaps of Kaldewei whirl baths.



INVISIBLE VENTILATION.

The ventilation that is often required for whirl baths is ensured by a nearly invisible edge on the underside of the panelling. Since the lower aluminium profile is firmly sealed to the finished floor, no water can escape and flow under the whirl bath.

VERSATILE INSTALLATION AND PANELLING VARIATIONS.

Rectangular baths:

Niche

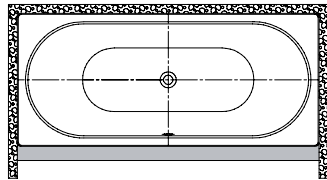

Corner left/right

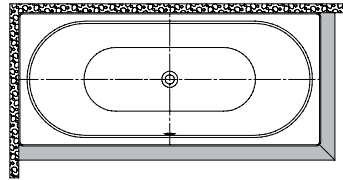

Freestanding

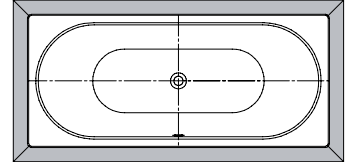

Long side against wall

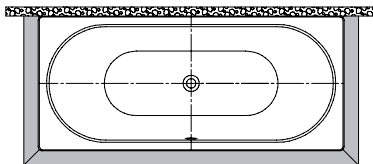

Short side against wall

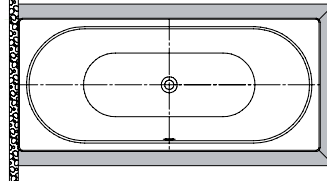

Oval baths:

Freestanding

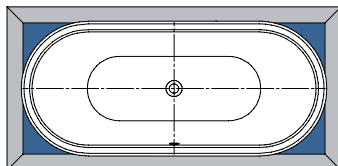

CENTRO DUO 2

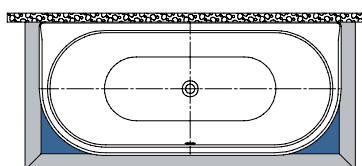

CENTRO DUO 1 left/right

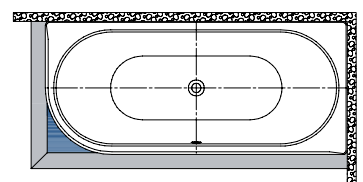

Octagonal baths:

Freestanding

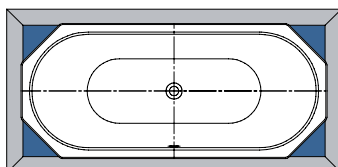

Hexagonal baths:

Corner installation

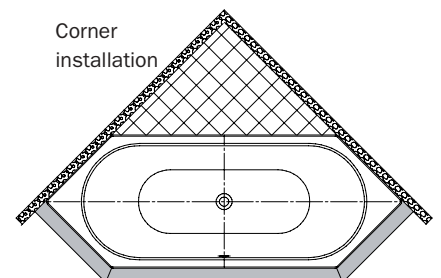

MULTIVERSO cannot be fitted against curved forms (e.g. oval baths).

For oval and octagonal baths, filler pieces are used to fill out the missing corners.

THE SYSTEM FOR SUCCESS. INSTALLATION ELEMENTS AT A GLANCE.

THE ALUMINIUM PROFILE.

The understructure of MULTIVERSO consists of a stable aluminium profile with a facing strip on the underside to attach it to the floor.

THE MAGNETIC HOLDERS.

Magnetic holders that can be adjusted in depth ensure that the panels are always aligned straight.

THE CORNER CONNECTIONS.

Screws attach each long section to a short section easily and securely.



THE PANELS.

The panels can easily be shortened to fit the installation height, enabling flexible finishing of the surface in various materials.

THE EDGE AND SIDE ANCHORS.

Two edge anchors on the long section and one edge anchor on the side section ensure the secure mounting of the whirl bath. Additional support is provided by side anchors on the long section, which, like the edge anchors, are adjustable.

THE HEIGHT ADJUSTMENT.

The height of each support can be adjusted with the help of the scale.

STEP BY STEP TO PERFECT PANELLING.

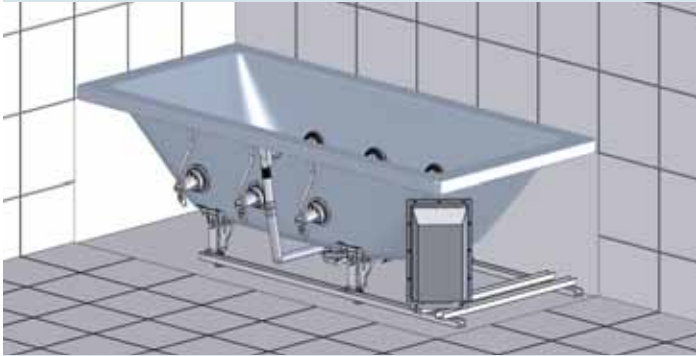

1

Mount the whirl bath according to the installation instructions.

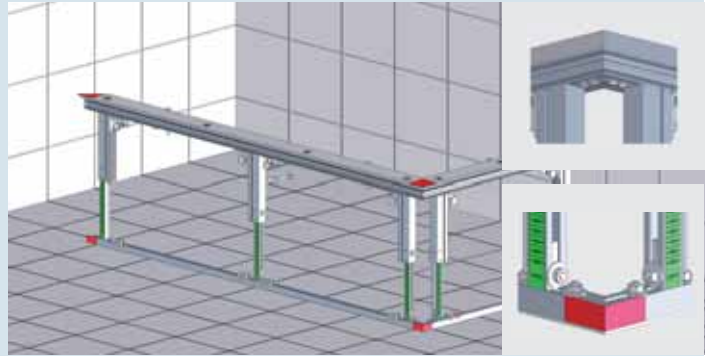

2

Put the MULTIVERSO long and side sections together at the corners and tighten the screws in the angle brackets. Shorten the long and side sections according to the installation situation. When installing a freestanding or hexagonal bath, use the elements in their full length. When installing an octagonal or oval bath, mount the filler pieces now.

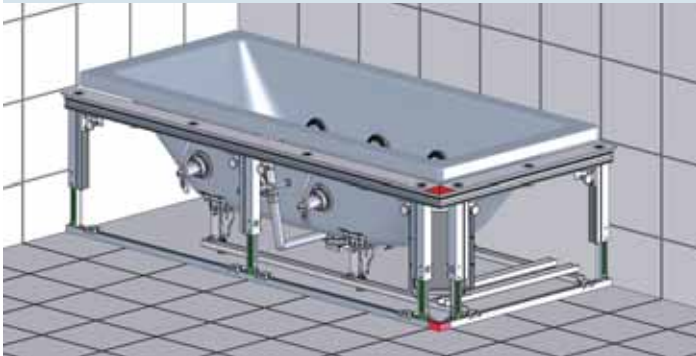

3

Adjust the frame to fit the height of the whirl bath and mount it on the bath with the help of the edge and side anchors. An additional attachment to the wall is not necessary. The elements stand directly on the tiles and are affixed by means of the adhesive strip on the underside of the frame.

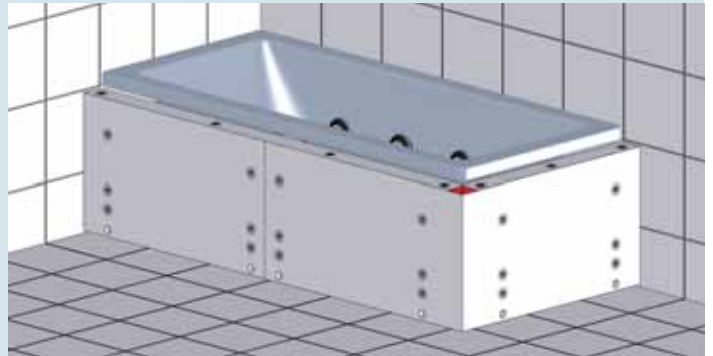

4

Shorten the panels in accordance with the height of the bath and insert them in the frame. When doing so, make sure they are 1 cm shorter than the height of the bath in order to leave room for ventilation through the lower edge and to ensure the panels can be tilted open.



5

Sheathe the front and sides with tile, granite, wood or other material as desired. Check that all flaps can be opened and closed easily.



6

Seal the whirl bath and MULTIVERSO. Please note: The lower edge must NOT be sealed.

SELECTION TABLE WHIRL BATHS.

MULTIVERSO can be used with the following Kaldewei whirl baths:

RECTANGULAR BATHS

Rectangular baths are always installed with the required number of long section and side section elements. These elements enable installation in a niche, corner or against the wall, as well as freestanding installation.

MULTIVERSO is available in the following sizes:

Long sections 150, 160, 170, 180, 190 and 200 cm

Side sections 70, 75, 80, 90 and 100 cm

OVAL BATHS

Oval baths are always installed with two long and two side sections, in addition to four design-based filler pieces. As with rectangular baths, a niche, corner, wall or freestanding installation is possible; however, a surrounding edge of 8 cm is required.

Model	Model No.	Length (cm)	Width (cm)
CENTRO DUO OVAL	127	170	75
CENTRO DUO OVAL	128	180	80
CENTRO DUO 2*	131	170	75
CENTRO DUO 1 left/right**	129/130	170	75
MEGA DUO OVAL	184	180	90
NOVOLA DUO OVAL/ NOVOLA DUO OVAL STAR	260/270	180	80
VAIO DUO OVAL	951	180	80

*CENTRO DUO 2 (Model No. 131)

At least one long section and two side sections are required for panelling the CENTRO DUO 2, in addition to two filler pieces. The shape of the whirl bath lends itself best to installation against a wall.

**CENTRO DUO 1 left/right (Model No. 129/130)

At least one long section and one side section are required for panelling the CENTRO DUO 1 l/r, each of which are supplemented with one filler piece. The shape of the whirl bath lends itself best to left/right corner installation.

OCTAGONAL BATHS

Octagonal baths are always installed with two long and two side sections, in addition to four filler pieces. As with the rectangular baths, a niche, corner, wall or freestanding installation is possible; however, a surrounding edge of 8 cm is required.

Model	Model No.	Length (cm)	Width (cm)
NOVOLA DUO 8/NOVOLA DUO 8 STAR	258/259	180	80
RETRO 8/RETRO 8 STAR	822/823	180	90
RONDO 8/RONDO 8 STAR	708/709	170	75
RONDO 8/RONDO 8 STAR	718/719	180	80
VAIO DUO 8	953	180	80

HEXAGONAL BATHS

Hexagonal baths are installed using design-based solutions available as a complete set. The installation situation is always “perpendicular to the corner”, since an installation flush with the corner would not allow access to the rearmost aggregates (see installation examples on page 3).

Model	Model No.	Length (cm)	Width (cm)
CENTRO DUO 6	134	200	75
MEGA DUO 6	182	214	90
NOVOLA DUO 6/NOVOLA DUO 6 STAR	254/255	210	80
RETRO 6/RETRO 6 STAR	824/825	190	80
RONDO 6/RONDO 6 STAR	706/707	197	75
RONDO 6/RONDO 6 STAR	716/717	206	80
TWIN POOL	660	170	100
VAIO DUO 6	952	210	80
VAIO 6/VAIO 6 STAR	958/959	190	90

MULTIVERSO cannot be used with bath models KUSATSU POOL, PUNTA DUO 3, VAIO DUO 3 and STUDIO. In addition to Kaldewei whirl baths, the panelling system can also be used for Kaldewei baths without whirl system.



KALDEWEI

Europe's No.1 for baths

Franz Kaldewei GmbH & Co. KG
Beckumer Strasse 33-35
59229 Ahlen
Germany
tel. +49 2382 785 0
fax +49 2382 785 200
internet: www.kaldewei.com

AUSTRALIA

Bathe
12-18 Sydenham Road
Marrickville NSW 2204
Australia
tel. +61 2 9516 2633
fax +61 2 9516 2955
e-mail: sales@bathe.net.au

AUSTRIA

Kaldewei Österreich GmbH
Ottensheimer Str. 36
4040 Linz
Austria
tel. +49 2382 785 0
fax +49 2382 785 200
e-mail: info@kaldewei.de

BALTIC STATES

J. Neifeld
Vilnius
Lithuania
tel. +370 699 61931
fax +370 52 784 187
e-mail: j.neifeld@ivc.lt

BELGIUM

Egeda NV
Toekomstlaan 47
2200 Herentals
Belgium
tel. +32 14 22 26 08
fax +32 14 22 26 33
e-mail: info@egeda.be

CZECH REPUBLIC

Kaldewei CS, s.r.o.
Ohradní 61a
140 00 Praha 4
Czech Republic
tel. +420 241 092 150
fax +420 241 092 160
e-mail: info@kaldewei.cz

GREATER CHINA

Kaldewei Far East Ltd.
- Shanghai Rep Office -
Suite 1109 11th Floor,
Shanghai Times Square Office
93 Huai Hai Zhong Road
Shanghai 200021
China
tel. +86 21 3308 0608
fax +86 21 6391 0718
e-mail: kaldewei@china.com

Kaldewei Far East Ltd.
Representative Office Beijing
1730, 17th Floor, Qing Yun Modern Plaza
43 North San Huan Road West
Haidian District
Beijing 100086
China
tel. +86 10 621 35156
fax +86 10 621 30229
e-mail: kaldewei-bj@china.com

HUNGARY

Török Szaniter BT
Kiscelli u. 62
1032 Budapest
Hungary
tel. +36 1 2501846
fax +36 1 4301486
e-mail: kaldewei@kaldewei.hu

ICELAND

Trobeco
Laugavegi 71
101 Reykjavik
Iceland
tel. +354 5 113131
fax +354 5 627550
e-mail: trobeco@mmedia.is

ITALY

Kaldewei Italia GmbH
Via Julius Durst 44
39042 Bressanone (BZ)
Italy
tel. +39 0472 200 953
fax +39 0472 208 953
e-mail: info@kaldewei.it

JAPAN

Tform
Taiyo Kanamono Co.,Ltd.
3-15-34 Kozu Chuoku Osaka
Japan
tel. +81 6 6632 2838
fax +81 6 6633 7790
e-mail: info@tform.co.jp

MIDDLE EAST

Sanipex LLC
P.O. Box 30871
Dubai
U.A.E.
tel. +971 4 3395660
fax +971 4 3395671
e-mail: info@sanipexdubai.com

NETHERLANDS

Plieger B.V.
Koxkampseweg 6
5301 KK Zaltbommel
Netherlands
tel. +31 418 682 682
fax +31 418 680 143
e-mail: post@plieger.nl

NEW ZEALAND

Metrix
211 Wairau Rd., Takapuna
Auckland, NSMC
New Zealand
tel. +64 944 31333
fax +64 944 31340
e-mail: info@metrix.co.nz

POLAND

Kaldewei Polska Spółka z o.o.
ul. Słowikowskiego 1a
05-090 Raszyn
Poland
tel. +48 22 720 16 03
fax +48 22 720 16 05
e-mail: poczta@kaldewei.pl

ROMANIA

EU RO International
B-dul Dinicu Golescu,
nr. 41, sc. 3, ap. 67
Bucharest (Sector 1)
Romania
tel. +40 21 3161451
fax +40 21 3161452
e-mail: office@eurointl.ro

RUSSIA

V. Shmalts
Moscow
Russia
tel. +7 495 507 2872
fax +7 495 9966 753
e-mail: kaldewei@kaldewei.ru

SLOVAKIA

Kaldewei CS, s.r.o.
Ohradní 61a
140 00 Praha 4
Czech Republic
tel. +420 241 092 150
fax +420 241 092 160
e-mail: info@kaldewei.cz

SOUTH AFRICA

Yello Import and Distribution Pty.Ltd.
P.O. Box 26765
Hout Bay 7872
South Africa
tel. +27 21 791 9191
fax +27 21 791 9199
e-mail: kaldewei@yelloimport.com

SOUTH EAST ASIA

Kaldewei South East Asia Pte. Ltd.
61, Bukit Batok Crescent
#02-05 Heng Loong Building
Singapore 658078
Singapore
tel. +65 6899 2487
fax +65 6899 0287
e-mail: info@kaldewei.com.sg

SOUTH KOREA

Hyunwoo Trading Co., Ltd.
213-5 Nonhyun-dong, Gangnam-gu
Seoul 135-010
Korea
tel. +82 2 547 3522
fax +82 2 547 3589
e-mail: hyunwookr@hotmail.com

SPAIN

Kaldewei España, S.L.
Calle Salvador Espriu, 59-4º Puerta 1ª
08005 Barcelona
Spain
tel. +34 93 224 1150
fax +34 93 221 7444
e-mail: info@kaldewei.es

SWITZERLAND

Zentrallager Schweiz
Obere Dünnerstr. 24
4612 Wangen b. Olten
Switzerland
tel. +41 62 2052100
fax +41 62 2121654
e-mail: lager-wangen@kaldewei.de

UKRAINE

B. Byshovets
Kiev
Ukraine
tel. +380 50 3104265
e-mail: kaldewei@ua.fm

UNITED KINGDOM

Kaldewei UK Ltd.
Unit 7, Sundial Court
Tolworth Rise South
Surbiton
Surrey, KT5 9RN
United Kingdom
tel. +44 208 337 1441
fax +44 208 337 1998
e-mail: info@kaldewei-uk.com

UNITED STATES/CANADA/ MEXICO/CARIBBEAN

Matrix North America
532 Broad Street, 2nd Floor
Bloomfield, New Jersey 07003
United States
tel. +1 973 329 5001
fax +1 973 329 5011
e-mail: kaldewei@matrixna.com