

# CORNEZZA

- striking pentagonal shower tray
- space-saving shape
- generous standing area with lots of room to move when showering
- elegant corner solution
- made of KALDEWEI steel enamel
- flush-fitting recessed waste cover (only in combination with the KA 90 waste fittings)



Similar illustration

Model 671 with support

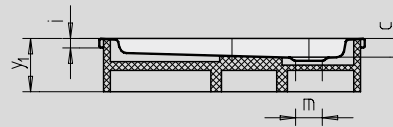

Model 670 with support

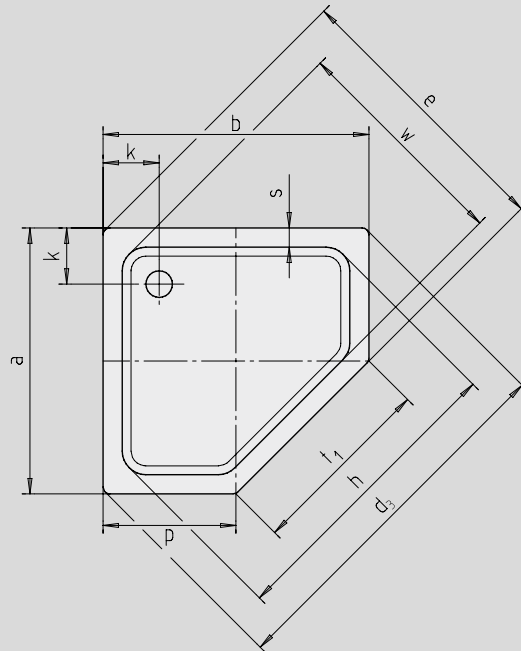
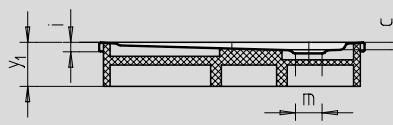

Modell	Combined Tray & Waste depth				Waste fitting depth			
	670	672	671	673	670	672	671	673
KA 90	105	105	145	145	81	81	81	81
KA 90 extra flat	94	94	134	134	70	70	70	70
KA 90 ultra flat	85	85	125	125	61	61	61	61
KA 90 vertical	49	49	49	49	81	81	81	81

See page 275.

Model No.	670	672	671	673	
External length	a	900	1000	900	1000 mm
External width	b	900	1000	900	1000 mm
Depth	c	25	25	65	65 mm
Corner dimension - external length	d <sub>3</sub>	1254	1395	1254	1395 mm
Corner dimension - external width	e	945	1051	945	1051 mm
Corner dimension - internal length	h	1023	1164	1023	1164 mm
Height of rim	i	32	32	32	32 mm
Distance tray edge to centre of drain hole	k	190	190	190	190 mm
Diameter of drain hole	m	90	90	90	90 mm
Side length	p	450	500	450	500 mm
Width of rim	s	65	65	65	65 mm
Width of access area	t <sub>1</sub>	636	707	636	707 mm
Corner dimension - internal width	w	765	871	765	871 mm
Height with support	y <sub>1</sub>	120	120	160	160 mm
Weight of the enamelled shower tray in kg		19	23	20	24
Anti-slip		∅ 435	∅ 588	∅ 435	∅ 588 mm