

STUDIO LEFT STUDIO STAR LEFT

- harmoniously designed corner bath with left and right installation options
- generously proportioned area for the back and integrated arm rests
- made of KALDEWEI steel enamel
- also available with panel and grips

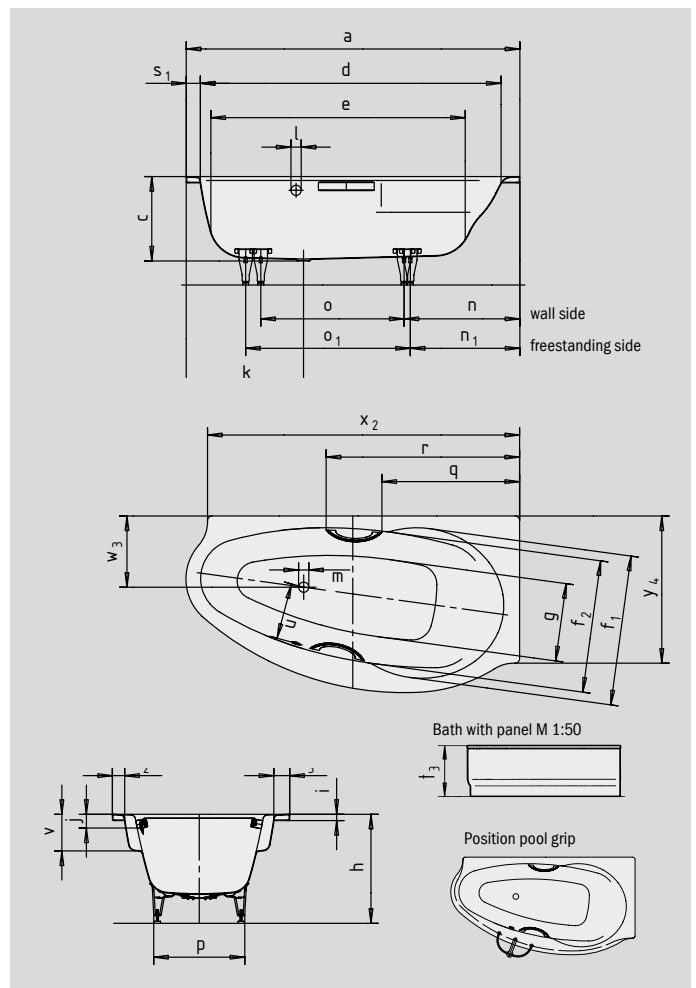

Similar illustration



GRIP DISCREET OPULENCE



(not for Mod.
828-2, 828-3,
829-2, 829-3)

| Model No. | | 828 / 829 |
|---|--|----------------|
| External length | a | 1700 mm |
| External width | b | 900 mm |
| Depth | c | 430 mm |
| Internal length (top) | d | 1545 mm |
| Internal length (bottom) | e | 1290 mm |
| Internal width (top) | f ₁ ; f ₂ | 765; 675 mm |
| Internal width (bottom) | g | 340 mm |
| Height with feet | h | 550-575 mm |
| Height of rim | i | 32 mm |
| Distance top edge to centre of overflow hole | j | 70 mm |
| Distance bath edge to centre of drain hole | k | 600 mm |
| Diameter of overflow hole | l | 52 mm |
| Diameter of drain hole | m | 52 mm |
| Distance foot end of bath edge to centre of foot | n; n ₁ | 590; 558 mm |
| Distance between the feet | o; o ₁ | 745; 880 mm |
| Max. width of feet | p | 525 mm |
| Distance bath edge to where grip/handle starts (Mod. 829) | q | 702 mm |
| Distance bath edge to where grip/handle ends (Mod. 829) | r | 986 mm |
| Width of rim (foot end; lengthwise) | s ₁ ; s ₂ ; s ₃ | 75; 60; 140 mm |
| Height with support and panel | t ₃ | 560 mm |
| Distance between centre holes | u | 290 mm |
| Armrest depth | v | 200 mm |
| Distance bath (lengthwise) to drain hole | w ₃ | 363 mm |
| Side length (lengthwise) | x ₂ | 1590 mm |
| Side length (head end) | y ₄ | 750 mm |
| Water volume** in litres | | 149 |
| Weight of the enamelled bath in kg | | 54 |
| Anti-slip | | ∅ 288 mm |
| Full anti-slip | | 600 x 220 mm |

Note: The operational system may protrude on some whirl systems.
Please refer to the Technical Information for Whirl Systems for further information.
Subject to technical alterations, tolerances and errors. Similar illustration.
** 70 litres displacement on average.